

NEW INTEGRATED OVERRIDE LOCKSET

Patient independence with integrated emergency staff access

We listened to clinicians who told us that their patients' thoughts, feelings and behaviours are greatly impacted by the environment and practices around them. Something as simple as the independence to lock and unlock their bedroom door can contribute to recovery. But patients are vulnerable and safety is their priority.

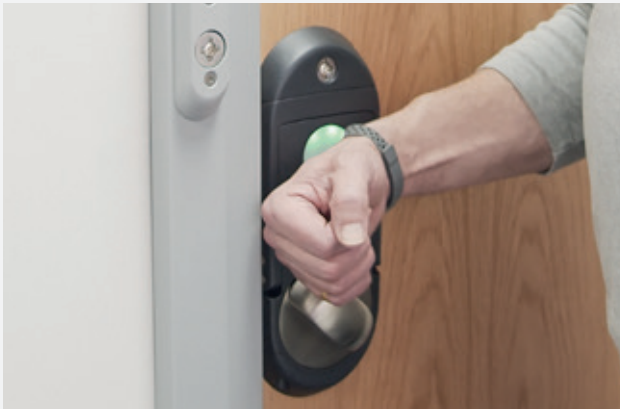

EMPOWERS PATIENTS AND AIDS RECOVERY

- We've designed a new electronic lockset that combines safety, security and independence
- Patients are empowered as they're able to lock and unlock their bedroom door - using our anti-ligature wristband developed specifically with patients' comfort and safety in mind



REDUCES ACCESS TIME AND TOOLS REQUIRED

- Built-in emergency override ensures staff can overcome the most determined barricades in just 5 seconds
- Staff gain emergency access using our anti-tamper Lifeline key - the same key that operates the vision panel and anti-barricade stop
- Staff only need one access credential (i.e. card or fob) to open all relevant doors
- No toolkit required

OVERCOMING DETERMINED BARRICADES IN 5 SECONDS

SAFEHINGE PRIMERA[®]
LIFESAVING DETAILS

While barricades are rare, they do happen and it's important that clinical staff are confident in overcoming them to resolve a hostage scenario or to help a service user attempting self-harm. That's why we've developed this electronic lockset with the mechanical override integrated into the lockset, to ensure it's ready for quick, reliable access.

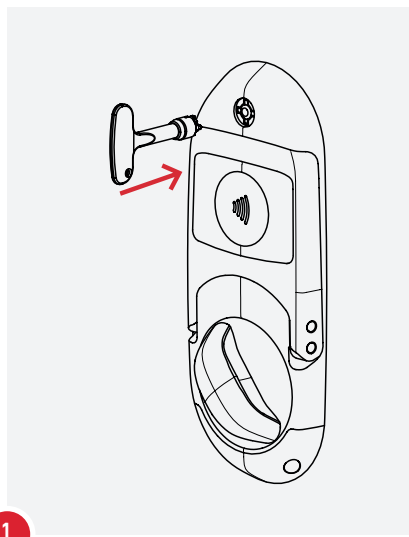

1

Activate the emergency lever using the staff-only Lifeline key

The same key is used to operate our vision panel and anti-barricade stop. In an emergency, the integrated override can be operated within 5 seconds.

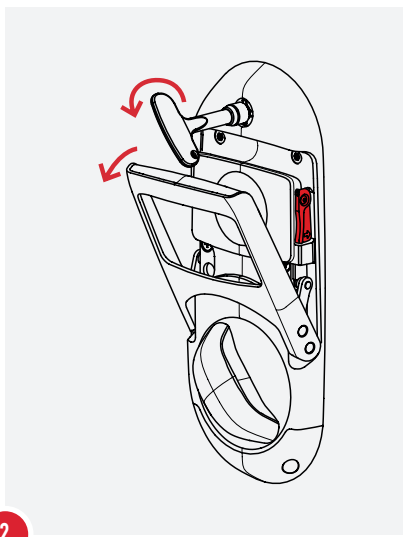

2

Once activated, the emergency lever will automatically eject. You then push down on the lever to the horizontal position to unlock the door.

The internal ratchet mechanism deactivates the internal turn/pull and prevents the service user from re-locking the door or holding it from the inside. In more extreme situations, the safety spindle will shear under heavy resistance.

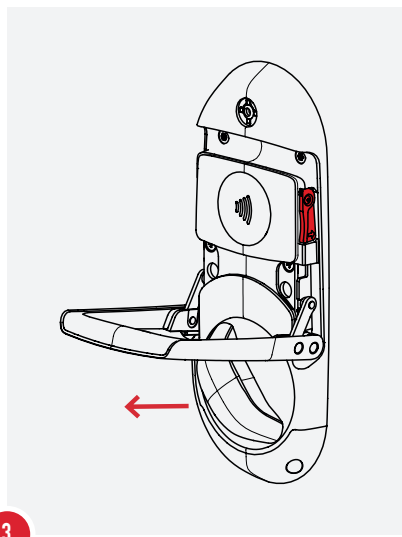

3

Use the emergency lever to pull the door open

This handle provides a strong, comfortable grip, giving you advantage over the internal turn/pull and allowing you to overcome a service user's attempts to hold the door shut.